



Pure water made easy



# INDEX

## COMPANY PROFILE

ABOUT US.....4  
 BRAND STORY.....6  
 OUR PROMISE & MILESTONES.....7  
 TEST CENTER, TRAINING & MARKETING ACTIVITIES...8~9  
 CERTIFICATES.....10~11

## R.O. WATER SYSTEM

COMPACT R.O. ....12~15  
 DIRECT FLOW R.O. ....16~19  
 CASING TYPE R.O. ....20~21  
 QUICK CHANGE FILTERS R.O. ....22~25  
 RESIDENTIAL R.O. ....26~29  
 COMMERCIAL R.O. ....30~31

## WATER FILTERS

WATER FILTER .....32~41  
 COMMERCIAL QUICK CHANGE WATER FILTERS.....42~43  
 TAP FILTER.....44~47  
 PITCHER.....48~49

## SHOWER FILTERS

HAND SHOWER FILTERS.....51 · 53  
 WALL MOUNTED SHOWER FILTERS .....52

## REPLACEMENT CARTRIDGES

CARTRIDGES.....54~55

# PRODUCTS

**01-1**  
 COMPACT R.O. SERIES  
 UNDER SINK TYPE

TAIWAN EXCELLENCE 2013

ROC-189(page-13)      ROC-188(page-13)      ROC-100(page-14)      ROC-168(page-15)

**01-2**  
 DIRECT FLOW R.O. SERIES  
 UNDER SINK TYPE

TAIWAN EXCELLENCE 2016

ROF-700(page-17)      ROF-808(page-18)      RO-808(page-18)

**01-3**  
 CASING TYPE  
 R.O. SERIES

RO-700 & RO-710(page-21)

**01-4**  
 QUICK CHANGE FILTERS  
 R.O. SERIES  
 UNDER SINK TYPE

TAIWAN EXCELLENCE 2016

ROQ-3815(H)(page-23)      ROQ-T815(page-23)      ROQ-O404(page-24)      ROQ-O414(page-24)

ROQ-A415E(page-25)      ROQ-3404(page-25)      ROQ-3405(page-25)

**01-5**  
 RESIDENTIAL R.O. SERIES  
 UNDER SINK TYPE

ROP-405(page-27)      ROP-415(page-27)      RO-404(page-28)      RO-405(page-28)

RO-416ST(page-29)      RO-416SG(page-29)

**01-6**  
 COMMERCIAL  
 R.O. SERIES

ROT-816(page-31)      ROT-817(page-31)

# PRODUCTS

**02-1**  
WATER FILTER SERIES

CTME-301 (page-33)      CTME-303 (page-33)      CTE-200 (page-35)      UTE-200 (page-35)

CTE-210 (page-36)      UTE-210 (page-36)      UWF-Q201 (page-37)      UWF-Q301 (page-37)      UWF-Q401 (page-37)

UWF-Q121 (page-38)      UWF-Q211 (page-38)      UWF-Q231 (page-39)      UWF-Q232 (page-39)

**02-2**  
HYDROGEN WATER

CWF-A101C (page-40)      CWF-A201CW (page-40)      CWF-T101 (page-40)      CWF-L009 (page-41)

**02-3**  
COMMERCIAL QUICK CHANGE WATER FILTER SERIES

UWF-Q241 (page-43)      UWF-Q141 (page-43)

**02-4**  
TAP FILTER

FF-5800 (page-45)      FF-5600 (page-47)      FF-5601 (page-47)

TAIWAN EXCELLENCE 2014

**02-5**  
PITCHER SERIES

PI-06W (page-49)      PI-02W (page-49)

**03-1**  
SHOWER FILTER SERIES

HSF-126 (page-51)      SF-123FM (page-52)      HSF-127 (page-53)

TAIWAN EXCELLENCE 2014      TAIWAN EXCELLENCE 2017



## ABOUT US



GROUND AREA:8,504 M<sup>2</sup> ,PLANT AREA:8170M<sup>2</sup>

### COMPANY INTRODUCTION

Easywell Water System Inc. was established in 1986. In 1990, the company accomplished a major change to a RO water system manufacturer and water filter supplier as well as diverter valve, water drinking faucet, shower filter, filter cartridge, feed water adaptor...etc.

Although we are OEM and ODM customized manufacturer, easywell offers you special inquiry of water filter or RO systems speedy, such as using your brand logo on water filter, or using your special media in filter cartridge, which can be in a small number of diverse.

Also easywell insists to use non-toxic of glue for assembling diverter valve and water drinking faucet...etc, and non-toxic lubricant for O-rings as well as assembling into plastic housing...etc. And there is no recycle plastic material using on them.

We obtained 5 different of NSF certificates of in-line post filters 、 water drinking faucets 、 sediment filters 、 membranes (please refer page 10), as well as CE marks 、 9 items of Taiwan Excellence Awards 、 Taiwan Water Saving certificate honored by Taiwan's government.

Also our RO water system & water filter products were sold for 54 countries, there are more than 700 million families using our water filter around the world.

We set up a professional Laboratory since 1992, there are 41 test equipment in easywell test center. All of components and products must be 100% leaking test before shipment.

In order to let you disburden to use easywell's products, we are buying USD1,000,000 - global products liability insurance annually. (Refer to page 41)

Up to now easywell totally obtained 91 patents around USA 、 Malaysia 、 China 、 Taiwan...





## FACTORY FACILITIES

Office



Laboratory



Auto Filling Machine



Production Line



Plastic Injection machines

Warehouse



Damp Proof Room



Filter Assembling Room

## FRANCHISE STORES

Our 5 franchise stores in Taiwan  
(our Chinese brand name is **ALYA 歐漾**)



## BRAND STORY

Let's start the story from the beautiful molecular structure of water:

Water, the most basic and important element in human body is pure in essence. A Japanese scholar, Emoto Masaru, has studied 8 years of his research by travelling around the world and visiting famous rivers and lakes. In his book "The Hidden Message in Water" published 122 photos about water crystals. Mr. Emoto claimed that water crystal will be full of vitality when it flows under some harmony resonance. Such as: Music.

Easywell founder, Mr. Rodger Lin believes in heart that the pure water is absolutely beautiful. It has been 28 years. Easywell has grown from angle valves manufacturer to water filters and cartridges producer. Because of hard working, focusing on QC as well as believing everyone should take potable water, our products have been sold for 46 countries and used by more than 7 millions families.

As the majority small and medium-sized enterprises, however, Easywell has minor opportunities to propose and realize our ideal products due to fulfill customers' requests and product customized goods. Mr. Lin said confidently that we would like to lead water filters into family as stylish appliances: artistic, convenient and practical.



Thus, the brand "ALYA" was born. "AL" means Europe in Chinese. To remember where Easywell's business started. "YA" in Chinese expresses glamorous and flowing of water. "ALYA" stands for "Always Your Advantages". This is the keystone for designing 'ALYA' products and it also indicate the brand aspiration.

ALYA believes firmly without any doubts that healthy potable water is good to human body. "Customers should not spend a fortune buying water filters through sales gimmicks. ALYA offers an respect and consideration for customers by designing and producing practical but stylish and convenient water filters." Mr. Lin emphasizes the ALYA commitment once again.

Spring end to early summer:

In paddy field next to factory, a hectare of green seedlings are absorbing sun lights, breeze and rain then growing gradually. The seedlings are waiting for farmers to irrigate, weed and dis-insects to grow into the rice.

In the factory next to the paddy field, a brand is growing as the seedlings. It is waiting for irrigating and given the nutrient. This brand is expecting an abundant harvest in the future.





## OUR PROMISE

### Our mission

Protects the terrestrial environment, creates healthy life for people.

### Our prospect

1. We are proud to provide our valued customer innovative products.
2. To provide our customer upmost satisfaction.

### Core value

Our staffs need to equip with honest personality, whom can grasp attentively to our customers and products, then display the best organization potency by teamwork.

### Our promise

All of our efforts are to ultimately satisfy our customers.

### Quality policy

1. Never compromise and insist in best quality.
2. Use top quality as our competition weapon.
3. Zero defect is our upmost goal.

### Goal of quality control

1. The number of re-processing in external less than 1 lot per month.
2. Supplier discrepancy ratio less than 2%.
3. External failure cost under US\$650.-per month.
4. Quality improvement more than 5 cases per month.

## MANAGEMENT PHILOSOPHY

PHILOSOPHY	PURPOSE
CUSTOMER RESPONSE	WE RESPOND QUICKLY TO CUSTOMER REQUIREMENTS
QUALITY	WE PURSUE ENDLESS QUALITY ENHANCEMENT
INNOVATION	WE ARE PROUD OF CONTINUOUS INNOVATIONS
EFFICIENCY	WE STRIVE FOR HIGHER EFFICIENCY

## MILESTONES

### 2018

- Set up internet on-line shopping website.
- Renewed ERP(Enterprise Resource Planning)

### 2017

- Received two 「Taiwan excellence award」.
- AIC-10 in-line filter obtained NSF certification again. (2017-2021)

### 2016

- Obtained 「Women Entrepreneurship Flying-Geene Program」.
- Expanded 3094 M<sup>2</sup> of plant.
- Water drinking faucet ZWDF-1002 obtained NSF listed. (2016-2020)

### 2015

- Obtained Taiwan Excellence Award for Ultra Violet Water Filter.
- Enlarged factory building up to 8504 M<sup>2</sup>.

### 2014

- Obtained The Raising Star Award from Taiwan Government.
- Obtained two Taiwan Excellence Awards for tap filter & shower filter.
- Registered Alya logo in 44 countries.

### 2013

- Received two 「Taiwan excellence award」.
- Renewed ERP(Enterprise Resource Planning)

### 2012

- Set up 「ALYA Water Systems, Inc.」 to promote own brand.
- Two shops opened in Taipei & Shinchu.

### 2011

- AIC-10 in-line filter obtained NSF certification. (2011-2015)

### 2010

- Built plastic injection factory.
- Launched Chinese own brand 「ALYA」

### 2008

- Registered  easywell Logo in 25 Europe countries.

### 2007

- Received Taiwan Small & Medium Enterprises Innovation Award.

### 2006

- Enlarged & completed New Factory Building To 5449M<sup>2</sup> (58630feet<sup>2</sup>).
- Renewed ERP (Enterprise Resource Planning).
- Completed MIS. (Management Information Systems).

### 2005

- Renewed CIS (Corporation Identify System).
- Installed SCM (Supply Chain Management).

### 2004

- Installed TQM (Total Quality Management)
- Installed MRP (Material Requirement Planning Management System).

### 2001

- Get ISO-14001 Approved. (October)

### 1999

- Get ISO-9001 Approved.

### 1997

- Bought 7595m<sup>2</sup> Of Land Started To Build A New Factory.

### 1994

- Built Corporation Identify System.

### 1993

- Ran ERP (Enterprise Resource Planning).

### 1990

- Bought A Plant In 222, Chia-Tung Rd., Sec. 2, Changhua Taiwan.

### 1986

- Easywell was Established.



## TEST CENTER



產品測試設備共19種 Total 19 items test Equipments (Quantity: 53)

品保耐久測試機	LIST FOR TESTING EQUIPMENTS	QUANTITY
鵝頸龍頭耐久測試機	GOOSENECK FAUCET CYCLE TESTER	6
切換開關耐久測試機	DIVERter VALVE CYCLE TESTER	8
RO純水機耐久測試儀	RO WATER SYSTEM CYCLE TESTER	1
水槌耐久測試機	WATER HAMMER TESTER (HOUSING/IN-LINE FILTER CYCLE TESTER)	16
鹽水噴霧測試機	SALT SPRAY TESTER	1
四面閥耐久測試機	SHUTOFF VALVE CYCLE TESTER	2
爆破測試機	BURST TESTER	1
電壓負載測試機	OVERLOAD TESTER	2
高低壓開關耐久測試機	HIGHT/LOW PRESSURE SWITCH CYCLE TESTER	2
增壓泵浦耐久測試機	BOOSTER PUMP CYCLE TESTER	2
電磁閥耐久測試機	SOLENOID VALVE CYCLE TESTER	1
HACH分析儀	HACH DR-3900 SPECTROPHOTO METER WITH RFID	1
拉力分析儀	TENSILE TESTER	1
耐黃變 老化試驗機	UV LAMP FADE & AGING TESTER	1
蓄壓測試機	WATER ACCUMULATING TESTER	10
PH質分析儀	PH METER	1
硬度分析儀	HARDNESS METER	1
濁度分析儀	TURBIDITY ANALYZER	1
壓差測試機	DIFFERENTIAL PRESSURE TESTER	1
餘氯測試機	DOSAGE MACHINE	1
振動測試機	VIBRATION TEST MACHINE	1
龍頭式濾水器測試機	TAP WATER FILTER TESTER	1

# TRAINING & MARKETING ACTIVITY

Brand Promotion

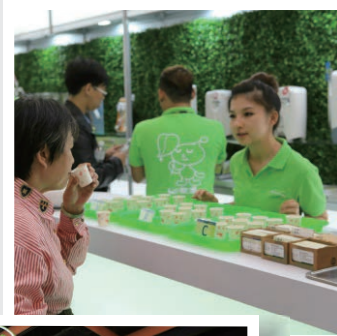

Campaign of Water Taste



Aquatech Exhibition

Exhibition at Taipei

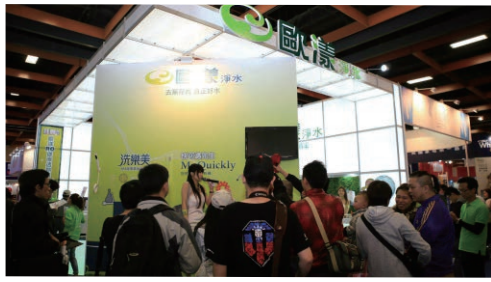

Local Marketing Activity-Water Bar



Cloth Donation

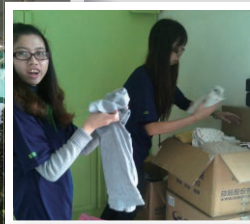

Taiwan Local Religious Festival

Water Quality Inspection for the Community



Clean Beach





# CERTIFICATES



Trade mark worldwide registered in 53 countries



Taiwan Innovation Award (ROF-808)



In-line filter, membrane, pressure tank, drinking faucet & sediment filter cartridge NSF approval (total:5 lists)



The raising star award



ISO-9001 Certificate



CE listed of Direct Flow R.O. Systems (total:10 models)



CE listed of other R.O. systems & water purification systems (total:35 models)

91 PRODUCTS USA,  
CHINA,  
MALAYSIA AND  
TAIWAN PATENTS  
(OCTOBER, 2017)



**TAIWAN  
EXCELLENCE  
2017**



Taiwan Excellence Award 2017  
for ZWDF-1002 lead free  
unique quarter-turn faucet

11 PRODUCTS WON THE TAIWAN EXCELLENCE AWARD FROM 2013 TO 2017



**TAIWAN  
EXCELLENCE  
2013**



Taiwan Excellence Award 2013  
for ROC-189 R.O. system



**TAIWAN  
EXCELLENCE  
2013**



Taiwan Excellence Award 2013  
for CTMD series water system



**TAIWAN  
EXCELLENCE  
2014**



Taiwan Excellence Award 2014  
for FF-5600 tap filter  
Water conservation award



**TAIWAN  
EXCELLENCE  
2014**



Taiwan Excellence Award 2014  
for HSF-126 shower filter



**TAIWAN  
EXCELLENCE  
2015**



Taiwan Excellence Award 2015  
for CTE-200 series water  
system



**TAIWAN  
EXCELLENCE  
2016**



Taiwan Excellence Award 2016  
for ROF700 Direct flow R.O.  
System



**TAIWAN  
EXCELLENCE  
2016**



Taiwan Excellence Award 2016  
for ROQ-3815 R.O. System  
with quick change filters



**TAIWAN  
EXCELLENCE  
2017**



Taiwan Excellence Award 2017  
for HSF-127 Shower filter





## COMPACT REVERSE OSMOSIS SERIES UNDER SINK TYPE

- All food grade materials where water is contacted.
- Functional components have been passed 100,000 times strict cycle testing under 150 PSI water pressure and 300 PSI (15 minutes)~500 PSI (instantaneous) burst test.
- With built-in tank.
- Easy installation.
- Fits conveniently under any kitchen sink.
- Easy-to-maintain, no tools required for replacement.
- LED light panel or LCD panel.
- Easy open access door.



## UNDER SINK COMPACT REVERSE OSMOSIS SYSTEM

Item No.	Fitting	Pump	Weight	Dimension (LxWxH) m/m	Measurement
ROC-188	JACO	non	10 kgs	430x240x420	2.9 cuft.
ROC-189	JACO	yes	13 kgs	430x240x420	2.9 cuft.

### STANDARD EQUIPMENT:

- 4-Way shutoff valve.
- 5 stages filter : 1st : in-line sediment filter 2.5"x11".  
2nd : in-line carbon filter 2.5"x11".  
3rd : in-line carbon filter 2.5"x11".  
4th : 50GPD NSF Membrane.  
5th : NSF In-line post coconut carbon 2"x10".
- Quarter-turn long reach faucet.
- Storage Tank 2.2 gallons (Built-in).
- Include tubes , water feed adapter, ball valve...etc.
- E-Z fittings connect are available.
- LED indicator to show water TDS (optional).
- LCD flow meter, filter change notice (optional).
- Leaking device is optional.
- Fixed ppm of TDS : 100 ppm

### SPECIFICATION:

- Flow rate of faucet : 2.5LPM
- Operating pressure : 60~80PSI (when using in no pump).

### OPTIONAL EQUIPMENT LIST

ITEMS	ITEM NO.	ROC-189	ROC-188
LED Water quality (100 ppm TDS) indicator		●	●
Auto shut-off Leaking device and alarm notice (item no. LD-4)		●	●
LED Water quality (100 ppm TDS) indicator with leaking sensor		●	
LED Leaking sensor only		●	
LCD flow meter, filter change notice		●	

- MOQ : 500 pcs if need special ppm unit of TDS probe
- MOQ : ALYA BRAND : NONE  
OEM/ODM : 300 PCS



**UNDER SINK COMPACT REVERSE OSMOSIS SYSTEM**

Item No.	Fitting	Pump	Weight	Dimension (LxWxH) m/m	Measurement
ROC-100	JACO	non	10 kgs	430x240x420	2.9 cuft.
ROC-101	JACO	yes	13 kgs	430x240x420	2.9 cuft.

**STANDARD EQUIPMENT:**

1. 4-Way shutoff valve.
2. 5 stages filter : 1st : in-line sediment filter 2.5"x11" .  
 2nd : in-line carbon filter 2.5"x11".  
 3rd : in-line carbon filter 2.5"x11".  
 4th : 50GPD NSF Membrane.  
 5th : NSF In-line post coconut carbon 2"x10".
3. Quarter-turn long reach faucet.
4. Storage Tank 2.2 gallons (Built-in).
5. Include tubes , water feed adapter, ball valve...etc.
6. E-Z fittings connect are available.

- LED water quality indicator is optional
- Leaking device is optional.
- Fixed ppm of TDS : 100 ppm

**SPECIFICATION:**

- Faucet flow rate : 2.5LPM
- Operating pressure : 60~80PSI (when no pump).

**OPTIONAL EQUIPMENT LIST**

ITEMS	ITEM NO.	ROC-100	ROC-101
LED Water quality (100 ppm TDS) indicator		●	●
Leaking device (item no. LD-4)		●	●
LED Water quality (100 ppm TDS) indicator with leaking sensor			●
LED Leaking sensor only			●

- MOQ : 500 pcs if need special ppm unit of TDS probe
- MOQ : ALYA BRAND : NONE  
 OEM/ODM : 300 PCS



Easy open access door



Patent no.  
 D134876 (Taiwan)  
 1280116 (China)



ROC-100  
 ROC-101

## UNDER SINK COMPACT REVERSE OSMOSIS SYSTEM

Item No.	Fitting	Pump	Weight	Dimension (LxWxH) m/m	Measurement
ROC-168	JACO	non	10 kgs	430x240x420	2.9 cuft.
ROC-169	JACO	yes	13 kgs	430x240x420	2.9 cuft.

### STANDARD EQUIPMENT:

- 4-Way shutoff valve.
- 5 stages filter : 1st : in-line sediment filter 2.5"x11".  
2nd : in-line carbon filter 2.5"x11".  
3rd : in-line carbon filter 2.5"x11".  
4th : 50GPD NSF Membrane.  
5th : NSF In-line post coconut carbon 2"x10".
- Quarter-turn long reach faucet.
- Storage Tank 2.2 gallons (Built-in).
- Include tubes , water feed adapter, ball valve...etc.
- E-Z fittings connect are available.

- LED water quality indicator is optional
- Leaking device is optional.
- Fixed ppm of TDS : 100 ppm

### SPECIFICATION:

- Faucet flow rate : 2,5LPM
- Operating pressure : 60~80PSI (when no pump).

### OPTIONAL EQUIPMENT LIST

ITEMS	ITEM NO.	ROC-168	ROC-169
Leaking device (item no. LD-4)		●	●
LED Water quality (100 ppm TDS) indicator with leaking sensor			●
LED Leaking sensor only			●

- MOQ : 500 pcs if need special ppm unit of TDS probe
- MOQ : ALYA BRAND : NONE  
OEM/ODM : 300 PCS



Easy open access door



Patent no.  
D134875 (Taiwan)  
1210935 (China)



ROC-168  
ROC-169



## DIRECT FLOW COMPACT REVERSE OSMOSIS SERIES UNDER SINK TYPE



TAIWAN  
EXCELLENCE  
2016



- All food grade material.
- Functional components have been passed 100,000 times strict cycle test under 150 PSI water pressure.
- Burst test : 300 PSI water pressure keeping 15 minutes & 500 PSI water pressure instantaneous.
- Tank not required, saving storage space & prevent to breed bacteria.
- Large flow rate : 1.3LPM

## UNDER SINK DIRECT FLOW COMPACT REVERSE OSMOSIS SYSTEM

- ◆ Inlet/outlet/drain fittings are hidden to prevent hurting
- ◆ Built-in filter clips
- ◆ Tool not required to open front panel.
- ◆ Low voltage input assuring safe electric.
- ◆ large pure water flow rate up to 1.3 LPM.

Specification	ROF-700
Installation Location	Under Sink
Water Output Method	Water Drinking Faucet
Dimension (m/m)	380x190x410 mm
Weight	10 kg
Voltage	110 or 220 V
Water Output Flow Rate	1.3 LPM
Applicable water pressure	65~100 PSI
Pump flow rate	2.75 LPM
No. of Membrane (NSF)	100GPD x 3pcs
Water Temperature	5~60°C
Salt rejection	94%

- MOQ : ALYA BRAND : NONE  
OEM/ODM : 300 PCS

### STANDARD EQUIPMENT:

1. Shutoff valve.
2. Booster pump with transformer 110V or 220V.
3. Quarter-Turn long reach faucet.
4. Include tubes , water feed adapter, ball valve...etc.
5. 6 stages filters.
  - 1st : 2.5"x11" in-line sediment filter.
  - 2nd : 10" NSF in-line coconut carbon filter.
  - 3rd~5th : 100GPD NSF membrane.
  - 6th : 2"x10" NSF In-line post coconut carbon.



1. Easy to replace filters & membrane in the front side.
2. Compact size.
3. Easy open access door.
4. Tank not required.



ROF-700



## DIRECT FLOW REVERSE OSMOSIS SYSTEMS

### STANDARD EQUIPMENT:

1. Solenoid valve.
2. Quarter-turn long reach faucet (when using in under sink).
3. Include tubes, water feed adapter, ball valve.....etc.
4. 7 Stages filter:
  - 1st : PP sediment (Quick change filter).
  - 2nd : Coconut carbon (Quick change filter).
  - 3rd : Coconut carbon (Quick change filter).
  - 4~6th : 100 GPD NSF Membrane x 3pcs.
  - 7th : GAC (6" in-line filter).
5. With larger water flow booster pump.

### FEATURES:

1. Less drain 1:1
2. Large pure water flow rate up to 1.3 LPM.
3. Enough nozzle altitude, good for 500 ml PET water bottle.

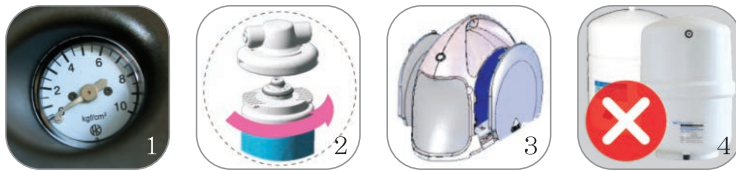

1. Built-in pressure gauge for easy reading membrane pressure.
2. Quick-change filter, change in seconds without tools.  
Using in stage no.1-3
3. Double access doors (opens without tool)  
for easy maintenance.
4. Tank is not required.
5. LED switch device.
6. LED light panel for filter change and auto shut-off while leaking and alarm notice.

## REVERSE OSMOSIS SYSTEMS WITH WATER PRESSURE TANK

### STANDARD EQUIPMENT:

1. Solenoid valve.
2. Include tubes, water feed adapter, NSF metal tank, ball valve..etc.
3. 5 Stages filter:
  - 1st : PP 5 micron sediment (In-line 12").
  - 2nd : Coconut carbon (In-line 12").
  - 3rd : PP 1 micron sediment (In-line 12").
  - 4th : 50GPD NSF membrane (one piecs).
  - 5th : NSF coconut carbon (In-line post).
4. With 4 gallon water pressure tank (metal).
5. With booster pump.

### FEATURES:

1. Built-in pressure gauge for easy reading membrane pressure.
2. NSF certified in-line post filter.
3. Double access doors (opens without tool) for easy maintenance.
4. LED switch device.
6. LED light panel for filter change and auto shut-off while leaking and alarm notice.



- MORE SPECIFICATION SHOWN ON NEXT PAGE.
- MOQ : ALYA BRAND : NONE  
OEM/ODM : 300 PCS



TAIWAN  
INNOVATION  
AWARD

Patent no.  
M277745 (Taiwan)  
803664 (China)  
7.368.055B2 (U.S.A.)

Green light push button  
for pure water outlet

pure water  
outlet nozzle

LED Monitor



ROF-801

ROF-808

Counter-Top Type



TAIWAN  
INNOVATION  
AWARD

Patent no.  
M277745 (Taiwan)  
7.368.055B2 (U.S.A.)

Green light push button  
for pure water outlet

pure water  
outlet nozzle





LED Monitor



(With Water Tank)

RO-808

Counter-Top Type

ROF-800 SERIES PRODUCT SPECIFICATIONS				
				
Specification	ROF-801	ROF-803	ROF-808	RO-808
Installation Location	Counter-Top	Under Sink	Counter-Top	Counter-Top
Water Outlet Method	Push button water outlet	Water Drinking Faucet	Green light push button for pure water outlet	Green light push button for pure water outlet
Dimension (m/m)	580x230x420	540x230x420	580x230x420	580x230x420
Weight	13 kgs	8 kgs	12 kgs	13 kgs
Voltage	110 or 220 V	Non booster pump	110 or 220 V	AC100~240V/240VDC
Water Output Flow	1.3 LPM	0.45LPM	1.3 LPM	2.5 LPM
Applicable water pressure	≤ 100 PSI	80~125 PSI	≤ 100 PSI	> 0 PSI
Pump flow	2.75 LPM	Non booster pump	2.75 LPM	1.2 LPM
No.of Membrane	100GPD x 3 pcs (NSF)			50GPD x 1 pc (NSF)
Water Temperature	5~54°C			
Salt rejection	94%			
Microprocessor Control	Non	Non	Yes	Yes
LED Monitor	Non	Non	Yes	Yes
Change Filter Reminder	Non	Non	Yes	Yes
Buzz Reminder	Non	Non	Yes	Yes
Measurement	3.3 cu.ft.			3.3 + 1.05 cu.ft.







## COMPACT REVERSE OSMOSIS SERIES

- All food grade materials where water is contacted.
- Functional components have been passed 100,000 times strict cycle test under 150 PSI water pressure and 300 PSI (15 minutes)~500 PSI (instantaneous) burst testing.
- Easy-to-maintain, no tools required for replacement.
- Easy open access door.



## COMPACT REVERSE OSMOSIS SYSTEM

- ◆ 4-Way shutoff valve
- ◆ NSF Ceramic disc faucet
- ◆ NSF storage tank 4 gallons, metal
- ◆ Include tubes, water feed adapter, ball valve... etc.

Specification	RO-700	RO-710
Installation Location	Under sink	
Water Output Method	Water Drinking Faucet	
Pre-filter type	in-line filters 1 <sup>st</sup> :PP sediment 5μ AIP-12 2 <sup>nd</sup> :GAC AIC-10 NSF 3 <sup>rd</sup> :PP sediment 1μ AIP-12	10"conventional filters 1 <sup>st</sup> :9-7/8" PP sediment 5M 2 <sup>nd</sup> :9-7/8" GAC 3 <sup>rd</sup> :9-7/8" CTO
NSF membrane Capacity	4th: 50GPD	4th: 50GPD
Post filter	5th: NSF in-line coconut carbon 10"	
Dimension (excl.tank)	380x190x410 mm	380x250x410 mm
Weight (excl.tank)	8 kgs	10 kgs
Water temperature	5~60°C	
Salt rejection	94%	
Standard fitting	JACO	
Faucet flow rate	3.5 LPM	

- MOQ : ALYA BRAND : NONE  
OEM/ODM : 100 PCS

### OPTIONAL EQUIPMENT:

1. Mixing valve.
2. Solenoid valve.
3. 3 in 1 electric controller.  
(auto flush + TDS monitor+leaking sensor)
4. E-Z fittings.

- Packing : 310 sets / 20 container. (RO-700)  
260 sets / 20 container. (RO-710)

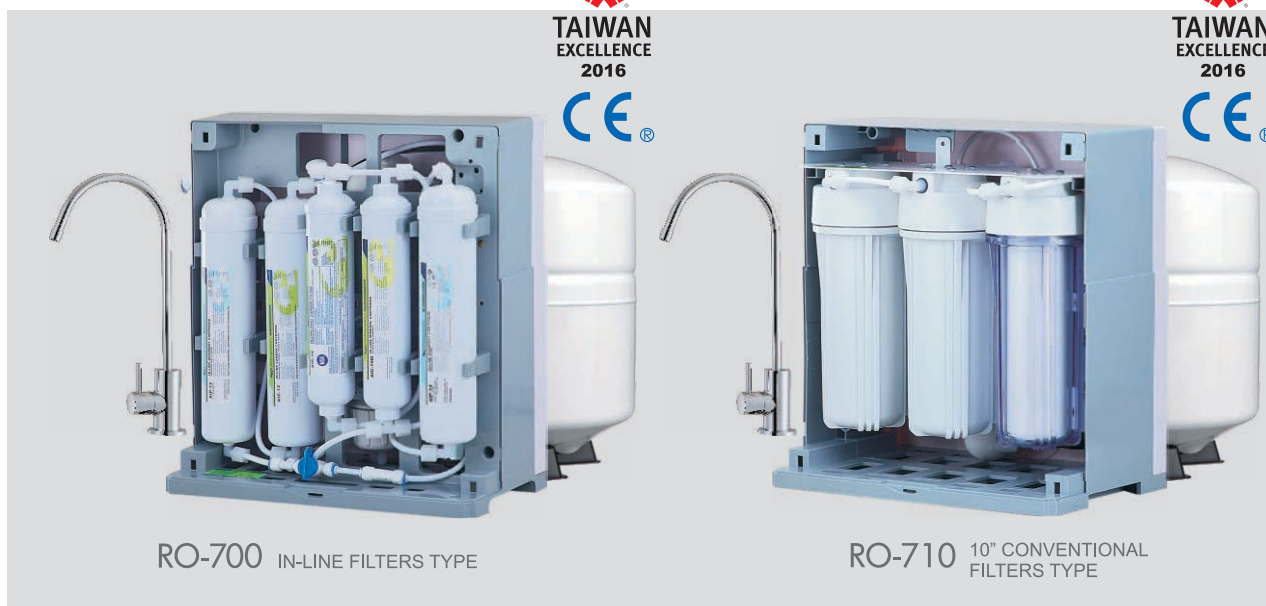

RO-700 IN-LINE FILTERS TYPE

RO-710 10" CONVENTIONAL FILTERS TYPE

## QUICK CHANGE REVERSE OSMOSIS SERIES UNDER SINK TYPE

- All food grade material where water is contacted.
- Completed set & functional components have been passed 300 PSI (15 minutes)~500 PSI (instantaneous) burst test & 100,000 times cycle test under 150 PSI water pressure.
- Quick change filter, tool not required.





## REVERSE OSMOSIS SYSTEM WITH QUICK CHANGE OR SCREW TYPE

- ◆ Quick change filters, tool not required.
- ◆ Save space & cost.

### 5 STAGES RO SYSTEM WITH BOOSTER PUMP

Specification/Model	ROQ-3815(H)	ROQ-T815
Pre-filter	1st: PP sediment 5 micron 2nd: Coconut granular activated carbon 3rd: PP sediment 1 micron	
NSF Membrane	4th: 50GPD	
Post filter	5th: NSF In-line coconut carbon	
Salt rejection	94%	
Valve	Solenoid	Solenoid
Weight(excl. Tank)	11.4 kgs	11.4 kgs
Dimensions (m/m)	300x170x420	300x170x420
Faucet water flow rate	3.5 LPM	
1st~3rd filters type	Quick change	Screw type

- MOQ : ALYA BRAND : NONE  
OEM/ODM : 300 PCS

#### STANDARD EQUIPMENT:

1. Booster pump with transformer 110V or 220V.
2. High & low pressure switch
3. Standard long reach faucet
4. Include wrench, tubes , water feed adapter, NSF metal tank, ball valve...etc.
5. NSF listed ceramic disc drinking faucet.

- Operating pressure :  $\leq 50$ PSI
- Pressure gauge is optional.



Quick change type



Screw type quick change cartridge



TAIWAN  
EXCELLENCE  
2016



ROQ-3815(H)



QCC-Type quick change filter



ROQ-T815



QTT-Type filter with auto shutoff device

## QUICK CHANGE REVERSE OSMOSIS WATER SYSTEM

- Compact size.
- Quick change (no need tools).
- 100V-240V wide range electronic transformer.
- All quick connectors.
- Quick change membrane.
- Quick change post carbon.
- Double O-ring housing.

**CAP OF QUICK CHANGE MEMBRANE HOUSING**

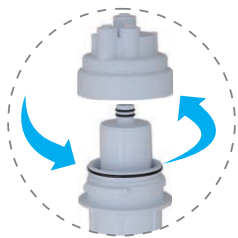
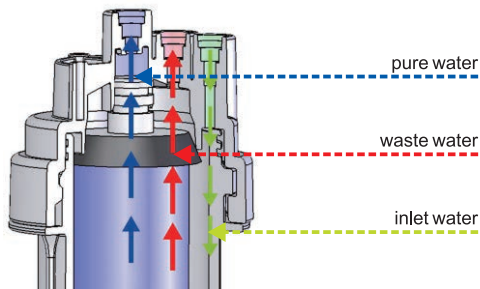

Quick change

**CAP OF QUICK CHANGE WATER FILTER HOUSING**

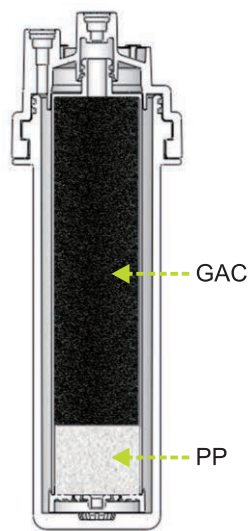

**SPECIFICATION:**

Item No.	ROQ-O404	ROQ-O414
Pump/Transformer	No	Yes (100V~240V)
Pre-filter type	1st: PP(Quick change) 2nd: GAC(Quick change)	
Membrane capacity	3rd: 50 GPD (Quick change)	
Post filter	4th: GAC(Quick change)	
4 way shutoff valve	Yes	Yes
High/Low pressure switch	No	Yes
Fitting type	Quick fitting	
Water output method	NSF Drinking water faucet	
Flow restrictor	Linear type 400 ml/min	
Storage tank	NSF Metal Tank 4 gallons	
Faucet flow rate	1.5LPM	

**COMPARISON OF CONVENTIONAL RO & QUICK CHANGE ROQ-O414**

Item No.	Conventional R.O.	ROQ-O414
Size	Too Big	40% Smaller
Quick Change Filter	No	Yes
Electronic Transformer	No	Yes
Quick Change Membrane	No	Yes

- MOQ : ALYA BRAND : NONE
- OEM/ODM : 300 PCS



## UNDER SINK REVERSE OSMOSIS WATER SYSTEM EQUIPPED WITH QUICK CHANGE FILTERS

### COMPARISON OF CONVENTIONAL RO & ROQ-A415

	Conventional RO	ROQ-A415E
Compact size	No	(↓20%)
Quick change filter	No	Yes
Flow rate of water output	3.5 liters/minute	4 liters/minute (↑15%)
Wide range power adaptor	Single voltage	100V~240V

- MOQ : ALYA BRAND : NONE  
OEM/ODM : 300 PCS

#### FEATURES:

- Compact size
- Quick change filters (no need tools)
- Big water output
- All quick connectors
- Double o-ring housings.
- Lead-free drinking faucet NSF listed.

#### STANDARD SPEC:

- NSF tank-3.2 gallon metal (volume 12 liters).
- 4 way shutoff valve.
- High pressure switch & low pressure switch.
- Electronic type booster pump-50 GPD.
- Wide range power transformer :100~240V
- Quick fittings.
- Ceramic disc faucet NSF listed.

#### CARTRIDGE:

- 1st : melt blown sediment 5 micron.(Quick change)
- 2nd : GAC.(Quick change)
- 3rd : carbon block.(Quick change)
- 4th : NSF membrane : 50 GPD.
- 5th : 10" NSF in-line post carbon cartridge.

Quick change filter double o-ring housing.

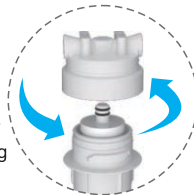

Patent no.  
M422922 (Taiwan)

**COMPACT  
EASY CHANGE FILTER  
BIG FLOW RATE: 4 LPM**



ROQ-A415E

### 4 or 5 Stages RO System W/O Booster Pump

Specification/Mode	ROQ-3404	ROQ-3405
Number of stage	4 stages	5 stages
Pre-filter	1st: PP sediment 2nd:GAC	1st: PP sediment 5 micron 2nd: Granular activated carbon 3rd: PP sediment 1 micron
NSF Membrane	50GPD	
Post filter	GAC quick change	NSF In-line GAC
Weight(excl. Tank)	4 kgs	4.5 kgs
Dimensions (m/m)	386x145x392	386x145x392

- All kinds of carbon are using granular coconut carbon.
- MOQ : ALYA BRAND : NONE  
OEM/ODM : 300 PCS

#### STANDARD EQUIPMENT:

1. 4-way shutoff valve.
  2. Ceramic disc faucet NSF listed.
  3. Include wrench, tubes , water feed adapter, NSF metal tank, ball valve...etc.
- Operating pressure: 50~80PSI

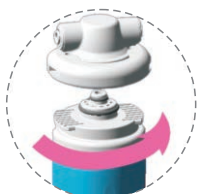

Equipped quick change filters, tool not required.



ROQ-3404



ROQ-3405



## RESIDENTIAL REVERSE OSMOSIS SERIES UNDER SINK TYPE

- All food grade material.
- Completed set & functional components have been passed 300 PSI (15 minutes)~500 PSI (instantaneous) burst test & 100,000 times cycle test under 150 PSI water pressure.



## MANIFOLD REVERSE OSMOSIS SYSTEM

- ◆ Built-in tubes and module system design.
- ◆ Less connect in fittings, less water leakage problems.
- ◆ Plastic material of bracket, prevents rust.
- ◆ With lead-free drinking faucet NSF listed.

Item No.	Fitting	Booster Pump	Weight (incl. Tank)	Measurement
ROP-405	JACO	non	10.5 kgs	2.92 cu.ft.
ROP-415	JACO	yes	13.5 kgs	2.92 cu.ft.

- MOQ : ALYA BRAND : NONE  
OEM/ODM : 300 PCS

### STANDARD EQUIPMENT:

1. 4-way shutoff valve.
2. 5 stages filter :
  - 1st : Melt blown sediment 5 micron.
  - 2nd : Carbon block.
  - 3rd : Melt blown sediment 1 micron.
  - 4th : 50GPD NSF Membrane.
  - 5th : NSF In-line post coconut carbon.
3. Ceramic disc faucet NSF listed.
4. Include wrench, tubes, metal tank, water feed adapter, ball valve...etc.

### REQUIRED PRESSURE OF INLET WATER :

- 50-80 PSI (W/O booster pump)
- ≤50 PSI (With booster pump)

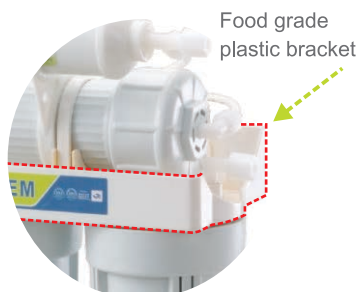

Food grade plastic bracket

- prevents rust

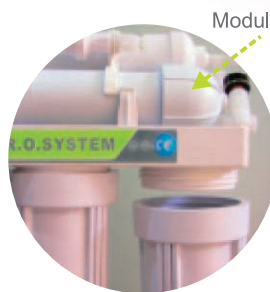

Module system design

- Less connect in fittings, less water leakage problems

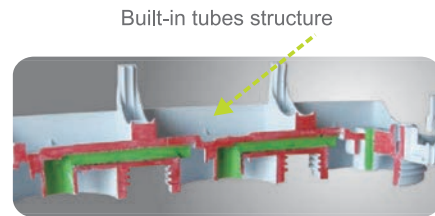

Built-in tubes structure

- Like car engine circuit design  
Patent no. M336818 (Taiwan)  
1117128 (China)



ROP-405

ROP-415

#### 4 STAGES REVERSE OSMOSIS SYSTEM W/O BOOSTER PUMP

No.	Fitting	Weight (incl. tank)	Measurement
RO-404	JACO	10 kgs	2.5 cu.ft.
RO-404E	E-Z	10 kgs	2,5 cu.ft.

- MOQ : ALYA BRAND : NONE  
OEM/ODM : 400 PCS

##### STANDARD EQUIPMENT:

1. 4-way shutoff valve.
2. 4 stages filter :
  - 1st : Melt blown sediment 5 micron.
  - 2nd : Carbon block.
  - 3rd : 50 GPD NSF Membrane.
  - 4th : NSF In-line post coconut carbon.
4. Ceramic disc faucet NSF listed.
5. Include wrench, tubes , water feed adapter, metal tank, ball valve...etc.
6. Bracket : Metal coated.



#### 5 STAGES REVERSE OSMOSIS SYSTEM W/O BOOSTER PUMP

No.	Fitting	Flush	Weight (incl. tank)	Measurement
RO-405	JACO	non	11 kgs	3 cu.ft.
RO-405E	E-Z	non	11 kgs	3 cu.ft.
RO-405H	JACO	Manual	11 kgs	3 cu.ft.
RO-405HE	E-Z	Manual	11 kgs	3 cu.ft.

- MOQ : ALYA BRAND : NONE  
OEM/ODM : 400 PCS

##### STANDARD EQUIPMENT:

1. 4-way shutoff valve
2. 5 stages filter :
  - 1st : Melt blown sediment 5 micron.
  - 2nd : Carbon block.
  - 3rd : Melt blown sediment 1 micron..
  - 4th : 50 GPD NSF Membrane.
  - 5th : NSF In-line post coconut carbon.
3. Ceramic disc faucet NSF listed.
4. Include wrench, tubes , water feed adapter, metal tank, ball valve...etc.
5. Bracket : Metal coated.

- **OPERATING PRESSURE:** 50-80PSI





## 6 STAGES REVERSE OSMOSIS SYSTEM

No.	Fitting	Flush	Weight (incl. tank)	Measurement
RO-416ST	JACO	Non	14 kgs	2.9 cu.ft.
RO-416STE	E-Z	Non	14 kgs	2.9 cu.ft.
RO-415TH	JACO	Manual	14 kgs	2.9 cu.ft.
RO-415THE	E-Z	Manual	14 kgs	2.9 Cu.ft.

- MOQ : ALYA BRAND : NONE  
OEM/ODM : 300 PCS

### STANDARD EQUIPMENT:

- 4-way shutoff valve.
- Booster pump with transformer 110V or 220V.
- High & low pressure switch.
- 6 stages filter :
  - 1st : Melt blown sediment 5 micron.
  - 2nd : Carbon block.
  - 3rd : Melt blown sediment 1 micron.
  - 4th : 50 GPD NSF Membrane.
  - 5th : NSF In-line post coconut carbon.
  - 6th : In-line mineral filter
- Ceramic disc faucet NSF listed.
- Include wrench, tubes , water feed adapter, metal tank, ball valve...etc.
- Bracket and frame : Metal coated.

- Inlet water pressure :  $\leq 50$ PSI



RO-416ST  
with Booster Pump

## 6 STAGES REVERSE OSMOSIS SYSTEM

No.	Fitting	Auto Flush (Microcomputer)	Weight (incl. tank)	Measurement
RO-416SG	JACO	Non	16 kgs	3.5 cu.ft.
RO-416SGH	JACO	Manual	16 kgs	3.5 cu.ft.

- MOQ : ALYA BRAND : NONE  
OEM/ODM : 300 PCS

### STANDARD EQUIPMENT:

- 4-way shutoff valve.
- Booster pump with transformer 110V or 220V.
- High & low pressure switch.
- 6 stages filter :
  - 1st : Melt blown sediment 5 micron.
  - 2nd : Carbon block.
  - 3rd : Melt blown sediment 1 micron.
  - 4th : 50 GPD NSF Membrane.
  - 5th : NSF In-line post coconut carbon.
  - 6th : In-line mineral filter.
- Ceramic disc faucet NSF listed.
- With pressure gauge.
- Include wrench, tubes , water feed adapter, NSF metal tank, ball valve...etc.
- Bracket and frame : Metal coated.

- Inlet water pressure :  $\leq 50$ PSI



RO-416SG  
with Booster Pump & pressure gauge.

## COMMERCIAL REVERSE OSMOSIS SERIES

- Completely Assembled, 100% factory tested.
- This system is economical designed for commercial application. Provide safe, pure water. It is suitable for workshops, restaurants, food processing industries, shopping centers, schools and hotels.



## COMMERCIAL REVERSE OSMOSIS SYSTEM

### STANDARD EQUIPMENT:

1. Solenoid valve
2. Booster pump 300GPD with transformer 110V or 220V
3. High & low pressure switch
4. 5 stages filter :
  - 1st : 20" PP sediment 5 micron
  - 2nd : 20" Carbon block
  - 3rd : 20" PP sediment 1 micron
  - 4th : 75GPD NSF Membrane x 2 pcs
  - 5th : NSF In-line post carbon
5. Metal bracket, white coating.
6. Include wrench, tubes , water feed adapter, ball valve...etc.

Item No.	Capacity	Weight	Dimension(m/m)	Measurment
ROT-816	150GPD	23kgs	250x450x670	4.8 cu.ft.

- MOQ : ALYA BRAND : NONE
- OEM/ODM : 100 PCS



ROT-816

### ASSEMBLY CHART:

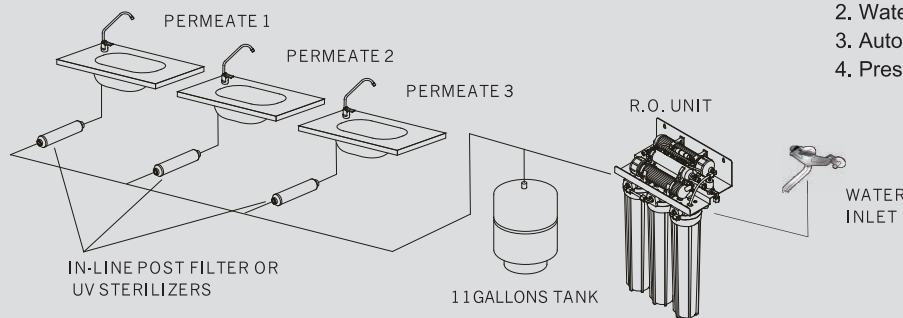

### OPTIONAL EQUIPMENT:

1. Storage tank
2. Water drinking faucet
3. Automatic flush controller
4. Pressure Gauge

## COMMERCIAL REVERSE OSMOSIS SYSTEM

### STANDARD EQUIPMENT:

1. Solenoid valve
2. Booster pump 300GPD with transformer 110V or 220V
3. High & low pressure switch
4. 5 stages filter :
  - 1st : 20" PP sediment 5 micron
  - 2nd : 20" Carbon block
  - 3rd : 20" PP sediment 1 micron
  - 4th : 100GPD NSF Membrane x 3pcs or 6pcs
  - 5th : NSF In-line post carbon
5. Metal bracket and frame, white coating.
6. Include wrench, tubes , water feed adapter, ball valve...etc.

### OPTIONAL:

1. 11 gallon storage tank.
2. Drinking faucet.
3. Pressure gauge.
4. Auto flush controller.

Item No.	Membrane	Capacity	Weight	Dimension(m/m)	Measurment
ROT-817	100GPDx3	300GPD	24kgs	250x480x770	6.1 cu.ft.
ROT-810	100GPDx6	600GPD	28kgs	250x480x770	6.1 cu.ft.

- MOQ : ALYA BRAND : NONE
- OEM/ODM : 100 PCS



ROT-817  
ROT-810  
(With Metal Bracket)





## WATER FILTER SERIES

- All food grade material.
- Completed set & functional components have been passed 300 PSI (15 minutes)~500 PSI (instantaneous) burst test & 100,000 times cycle test under 150 PSI water pressure.

# Mr.Quickly



## LED DUAL STAGE WATER FILTER

- ◆ Equipped with LED device, remind you to replace filters.
- ◆ Large flow diverter valve, applicable for high/low water pressure area.
- ◆ Carbon filter removes chemical, chlorine & odor.
- ◆ Sleep device performance, to extent battery life.
- ◆ flow rate : 1.8 LPM / 60 PSI

Item No.	Type	LED Monitor	Packing	Weight	Meas.
CTM-300	Counter top	No	4 pcs/ctn	11 kgs	2.4 cu.ft
CTME-301	Counter top	LED	4 pcs/ctn	11 kgs	2.4 cu.ft
CTM-302	Under sink	No	4 pcs/ctn	12 kgs	2.4 cu.ft
CTME-303	Under sink	LED	4 pcs/ctn	12 kgs	2.4 cu.ft

- MOQ : ALYA BRAND : NONE,  
OEM/ODM : 300 PCS
- Battery supply :  
1.5V x 2 , LR03 size or equivalent
- Dimensions (LxWxH) : 260x110x334 mm

### STANDARD EQUIPMENT:

1. 1.5V,LR03 batteries x 2pcs
2. Diverter valve 55/64"-27 x 1pc

### OPTIONAL ACCESSORIES:

1. Metal mounting bracket (for under sink type)

### CARTRIDGE PACKING LIST :

Item No.	Media	Capacity	No./case	Weight	Cu.ft
QCC-10P	Sediment (Polypropylene)	7,600 Liters	20	8 kgs	0.9
QCC-10C	GAC only	7,600 Liters	20	10 kgs	0.9
QCC-10USC	Hollow Fiber + Silver impregnated coconut carbon	5,600 Liters	20	9 kgs	0.9

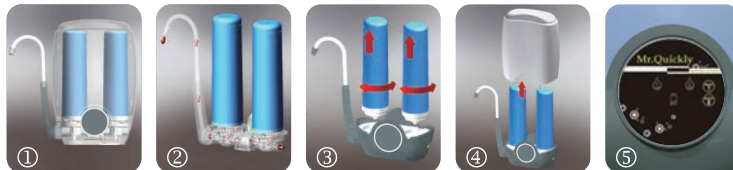

### ULTRAFILTRATION WITH FIBER CARBON CARTRIDGE



### FEATURES:

1. Twin Stage media : (1.) Sediment + Carbon Filter or (2.) Sediment+Hollow fiber with silver impregnated coconut carbon
2. Flow Direction
3. Quick change filters designed.
4. Easy open access door. (Changes without tools)
5. LED display.
  - Change filter reminder (light-on and alarm).
  - Set up 3 months for sediment filter.  
6 months for carbon filter.  
1 year for UF + silver carbon.
  - Slipping mode.

Patent no.  
D134874 (Taiwan)  
1214288 (China)



CTM-300 w/o Electric Device  
CTME- 301 with LED  
Counter-top type



CTM-302 w/o Electric Device  
CTME- 303 with LED  
Under sink type



## WATER FILTER SERIES

### 4 STAGES UV-LIGHT WATER FILTER

- Smart UV (Ultraviolet) lamp to remove virus & bacteria.
- 3 Stages pre-filters to remove sediment, chlorine and heavy metals.
- Quick change system helps replace filters quickly and easily.
- Both "Counter-top" and "Under-sink" are available
- No waste water produced.
- Automatically leakage detector informs.
- Flow rate : 1.8 LPM , at 60 psi.





## 4 STAGES ULTRAVIOLET WATER FILTER

Item No.	Type	UV lamp	Packing	Weight	Measurement
CTE-200	Counter top	yes	4 pcs/ctn	2.0 kgs/pc	5.6 cuft
UTE-200	Under sink	yes	4 pcs/ctn	2.0 kgs/pc	5.6 cuft

### CARTRIDGE:

Media & other	1st stage	2nd stage	3rd stage	4th stage
Filter media	QTT-10P	QTT-10C	QTT-10CKM	UV1S-4
Filter media	PP Sediment	Granular activated carbon	Silver granular activated carbon+KDF+Alkaline ball	UV Sterilizer
Capacity	7,600 Liters	7,600 Liters	7,600 Liters	2 Years

- MOQ : ALYA BRAND : NONE  
OEM/ODM : 300 PCS

### SPECIFICATION FOR UV:

Water Flow rate : 1.8 LPM  
Power : 2 watt(standby), 14 watt(working)  
Water pressure range : 1-5KG/CM<sup>2</sup> (15~70psi)  
UV lamp : 11W/UV254nm

### SMART UV LAMP OPERATION:

- Lasts automatically for 8 minutes after activation.
- UV lamp will turn off if there's no 2nd action in 8 minutes.
- Reminds oncoming failure with alarm.
- Reminds when the remaining lifetime of filter cartridges is less than 100 liters by flashing signal.
- Reminds when the remaining lifetime of UV lamp is less than 7 days by flashing signal.
- Turn off the signal of UV lamp automatically when the lifetime is expired.



e-monitoring system designed, easy to interpret filter life, and inform you with sound and graphics



Quick change filter design, tool not required.



Smart UV(Ultraviolet) lamp to remove virus & bacteria. UV lamp will turn off automatic, energy-saving and environmental protection

### FILTERS STATUS PANEL

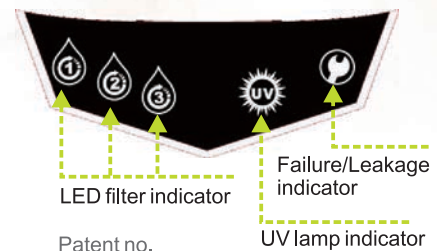

Patent no.  
D151704 (Taiwan)  
2071581 (China)  
12-00531-0101(Malaysia)



### 3 STAGES ULTRA FILTRATION WATER FILTER

Item No.	Type	UV lamp	Packing	Weight	Measurement
CTE-210	Counter top	non	4 pcs/ctn	1.7 kgs/pc	5.6 cuft
UTE-210	Under sink	non	4 pcs/ctn	1.7 kgs/pc	5.6 cuft

#### CARTRIDGE:

Media & other	Stages	1st stage	2nd stage	3rd stage
Filter media		QTT-10P	QTT-10UF	QTT-10SC
Filter media	PP Sediment	Hollow fiber with silver impregnated coconut carbon (Made in JAPAN or KOREA)	Silver impregnated granular activated carbon	
Capacity		7,600 Liters	6,000 Liters	7,600 Liters

- MOQ : ALYA BRAND : NONE  
OEM/ODM : 300 PCS

#### SPECIFICATION FOR ULTRAFILTRATION:

Hollow filter membrane Materials :

PS (NSF, made in Korea)

Pore size : 0.2 $\mu$ m

Liquid permeability : 13  $\pm$  1.5 (cc/cm<sup>2</sup> · min · (kgf/cm<sup>2</sup>))

#### FEATURE:

- 3 Stages pre-filters to remove sediment, chlorine and heavy metals
- Both "Counter-top" and "Under-sink" are available.
- No waste water produced.
- Automatically leakage detector informs.
- Flow rate : 1.8 LPM , at 60 psi.
- Carbon conforms to NSF listed.
- Counter accurate flow rate by mechanic flow meter.



#### ULTRA FILTRATION WITH FIBER CARBON CARTRIDGE



UTE-210 under sink  
(With NSF listed drinking faucet)

**UNDER SINK WATER FILTER WITH QUICK CHANGE FILTER**

Item No.	Stage	Packing	Weight	Measurement
UWF-Q201	Twin	8 pcs/ctn	13kgs	2.5 cu.ft.
UWF-Q301	Triple	4 pcs/ctn	10kgs	1.9 cu.ft.
UWF-Q401	Four	1 pcs/ctn	5kgs	0.66 cu.ft.

● MOQ : ALYA BRAND : NONE  
OEM/ODM : 300 PCS

- Quick change filter, changing in seconds without tool.
- UV Sterilizer (UWF-Q401)  
Material : SS304 stainless steel  
Inlet/outlet port : 1/4"  
Flow rate : 1.4 GPM  
Lifetime of UV lamp : 6000 hours  
Watts : 10W  
Power consumption : 110V or 220V

**STANDARD EQUIPMENT:**

1. QCC quick change cartridge  
Twin stage media : 1st : PP sediment,  
2nd : GAC  
Triple stage media : 1st : PP sediment,  
2nd : GAC, 3rd: GAC  
Four stage media : 1st : PP sediment,  
2nd : GAC,  
3rd : GAC, 4th: UV Sterilizer.
2. Metal bracket
3. Standard long reach faucet NSF listed.
4. PE tube 1/4"x 3'
5. Brass water feed adapter 1/2" with ball valve 1/4" or saddle valve



OR



- PP = Polypropylene
- GAC = Granular activated carbon



● Quick change filter change in seconds without tool.





## WATER FILTER WITH QUICK CHANGE FILTER & SHUTOFF DEVICE

Item No.	Stage	Packing	Weight	Measurement
UWF-Q121	Single	8 pcs/ctn	8.5 kgs	1.86 cu.ft.
UWF-Q211	Twin	4 pcs/ctn	8.5 kgs	1.86 cu.ft.

- MOQ : ALYA BRAND : NONE  
OEM/ODM : 300 PCS

### STANDARD EQUIPMENT:

1. Metal bracket
2. Standard long reach brass faucet NSF listed.
3. PE tube 1/4"x3'
4. Brass water feed adapter 1/2"  
with ball valve 1/4" or saddle valve

### PACKING

Item No.	Media		Cover
	1st stage	2nd stage	
UWF-Q121	GAC	Non	Non
UWF-Q211	P.P.	Granular Carbon	Non

- MOQ : 200 pcs
- All carbon media are using granular coconut carbon.
- Useful for Pre-filter.
- Ultra-filtration membrane for UWF-Q121 available.
- Customer-made media is welcome.

### SPECIFICATION

Item No.	Inlet & Outlet	Flow Rate
UWF-Q121	1/4" EZ	1.8 LPM
UWF-Q211	1/4" EZ	1.8 LPM



## WATER FILTER WITH QUICK CHANGE FILTER & SHUTOFF DEVICE

Item No.	Stage	Packing	Weight	Measurement	Flow rate
UWF-Q231	Twin	4 pcs/ctn	15 kgs	1.86 cu.ft.	4 LPM
UWF-Q232	Twin	4 pcs/ctn	16 kgs	1.9 cu.ft.	4 LPM

- MOQ : ALYA BRAND : NONE  
OEM/ODM : 300 PCS

### STANDARD EQUIPMENT:

1. Metal bracket
2. Standard long reach brass faucet NSF listed.
3. PE tube 1/4"x3'
4. Brass water feed adapter 1/2" with ball valve 1/4" or saddle valve

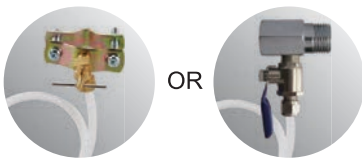

### PACKING

Item No.	Media		End cap cover	Flow rate
	1st stage	2nd stage		
UWF-Q231	P.P.	Granular Carbon	Non	4 LPM
UWF-Q232	P.P.	Granular Carbon	Yes	4 LPM

- All carbon media is using granular coconut carbon.
- Useful for Pre-filter.

### SPECIFICATION

Item No.	Inlet & Outlet	Flow Rate
UWF-Q231	1/4" EZ	1.8 LPM
UWF-Q232	1/4" EZ	1.8 LPM

- MOQ : ALYA BRAND : NONE  
OEM/ODM : 300 PCS

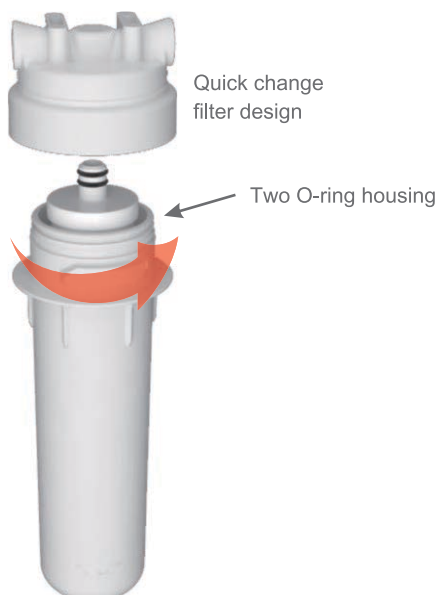

**UWF-Q231**  
PATENT NO.  
M422992 (TAIWAN)



**UWF-Q232**  
PATENT NO.  
M422992 (TAIWAN)

## COUNTER-TOP WATER FILTER

Item No.	Stage	Bowl	Packing	Weight	Meas.
CWF-A101C	Single	AS clear	8 pcs	13 kgs	2.1 cu.ft.
CWF-A201CW	Twin	AS+PP	4 pcs	13 kgs	2.5 cu.ft.

- MOQ : ALYA BRAND : NONE  
OEM/ODM : 500 PCS

### STANDARD EQUIPMENT:

1. HA-type housing. 10" bowl, 1/4" white end-cap.
2. Diverter valve.
3. 8" Curved spout.
4. Elbow for in/outlet.
5. PVC tube 1/4" or 3/8".
6. Faucet adapter.
7. Plastic wrench.



## STAINLESS STEEL COUNTER-TOP WATER FILTER

Item No.	Stage	Packing	Weight	Measurement
CWF-T101 Without cartridge	Single	8pcs	12kgs	1.4 cu.ft.
CWF-T101 With cartridge	Single	8pcs	16kgs	1.4 cu.ft.

- MOQ : ALYA BRAND : NONE  
OEM/ODM : 500 PCS

### STANDARD EQUIPMENT:

1. HT-type housing. 10" s.s. bowl, 1/4" white end-cap.
2. Diverter valve.
3. Elbow for inlet/outlet.
4. 8" Curved spout.
5. PVC tube.
6. Faucet adapter.
7. Plastic wrench.

### FEATURE:

1. Black color end-cap is available.
2. Air release device is available.
3. Dual function for counter-top or under sink.
4. Two hang holes for wall-mount.
5. Stainless steel bowl.

### OPTIONAL:

1. 2.5" x 9 7/8" carbon block cartridge.
2. 2.5" x 9 7/8" Ceramic cartridge
3. 2.5" x 9 7/8" PP sediment cartridge





## COUNTER-TOP WATER FILTER

- ◆ Easy to install without tool.
- ◆ No drain water, no electricity is needed.
- ◆ Drink good water and cost less.
- ◆ With 100% coconut granular activated carbon.
- ◆ To remove residual chlorine, pesticides, and bad odor from water.

Item No.	No./ case	Weight	Measurement
CWF-L009	8 pcs	15 kgs	2.1 cu.ft

- MOQ : ALYA BRAND : NONE  
OEM/ODM : 500 PCS

### STANDARD EQUIPMENT:

1. Diverter valve 1/4"
2. PVC tube 1/4"
3. External faucet adapter #ETA-02
4. Plastic or brass internal faucet adapter

### FEATURE:

1. Sealed (throw away) water filter.
2. Counter-top type.
3. Media: Granular activated carbon (included).
4. Easy connection with most of faucets in Kitchen.
5. Dimensions(WxDxH): 120X120X240mm

### SPECIFICATION

1. Capacity: 24,000 gallons
2. Aluminum sheet coated on filter.
3. Customized media is welcomed.



CWF-L009

**Global product liability Insurance** Insured Amount USD 1,000,000

 新光產物保險 SHINKONG INSURANCE	
<b>Certification of Liability Insurance</b>	
This certificate is issued as a matter of information only and conferred no rights upon the certificate holder. This certificate does not amend, extend or alter the coverage afforded by the Policies below. This is to certify that the policy of insurance listed below has been issued to the insured named above for the policy period indicated, notwithstanding any requirement, term or condition of any contract or other document with respect to which this certificate may be issued or may be issued or may pertain, the insurance afforded by the policy described herein is subject to all the terms, exclusions and conditions of such policy, limits shown may have been reduced by paid claims.	
<b>Company Affording Coverage :</b>	
SHINKONG INSURANCE CO., LTD. 15, Chienkuo N Rd, Sec 2, Taipei, Taiwan Tel:886-2-2507-5335 Fax:886-2-2516-4298	
<b>Name of Insured :</b>	
Easywell Water Systems, Inc. (益乾股份有限公司) No.222-1, Sec.2, Chia Tung RD, Changhua City, Changhua County, Taiwan (R.O.C.)	
<b>Policy Information :</b>	
Type of Insurance	: Commercial General Liability Insurance (Occurrence Form)
Policy Number	: 139006A3P0M00039
Period of Insurance	: 12 months, From Jan. 01, 2018 to Jan. 01, 2019 (noon to noon)
Limits of Liability	: Each Occurrence Limit USD 1,000,000.-
	: Products Liability Agg. Limit USD 1,000,000.-
	: Completed Operations Liability Aggregate Limit USD 200,000.-
	: Aggregate Limit During The Policy Period USD 1,000,000.-
Products Covered	: RO Systems, Water Filters, Cartridges, Pitchers, Tap Filters, Shower Filters and Accessories, which are manufactured/ distributed by the insured and sold to the Coverage Territory
Policy Territory	: Worldwide excluding Taiwan (R.O.C.)
<b>Certificate Holder/Additional Insured :</b>	
ELIJI OF AMERICA, ORA ARROW INDUSTRIES 465 N. BERRY STREET BREA, CA 92821 ATTN: Heidi Pearson heidi@arrowindustries.com PH: 714-674-0590/ FAX: 714-674-0170	
<b>Cancellation :</b> should any of the above described policy be cancelled before the expiration date thereof, the issuing company will endeavor to mail 30 days written notice to the certificate holder named to the above, but failure to mail such notice shall impose no obligation or liability of any kind upon the company, its agents or representative	
SHINKONG INSURANCE CO., LTD.  Eliza H.C. Lin, Manager Casualty Underwriting Dept. Authorized Signature	
Date:	<b>Dec. 27, 2017</b>
By	

## COMMERCIAL QUICK CHANGE WATER FILTER SERIES

- All food grade material where water is contacted.
- Completed set & functional components have been passed 300 PSI (15 minutes)~500 PSI (instantaneous) burst test & 100,000 times cycle test at 150 PSI water pressure.



**COMMERCIAL WATER FILTER  
(GOOD FOR COFFEE SHOP, RESTAURANT & CONVENIENCE STORE)**

**SPECIFICATION**

Item No.	Media	Capacity	Packing
UWF-Q141	Hollow fiber with Silver impregnated fiber carbon	15,000 liters	8sets/ctn
UWF-Q241	1st : PP Sediment filter 2nd : Hollow fiber membrane with Silver impregnated coconut carbon with frame	1st PP cartridge : 8,000 liters 2nd UF cartridge : 20,000 liters	4sets/ctn

● MOQ : ALYA BRAND : NONE  
OEM/ODM : 300 PCS

**STANDARD EQUIPMENT:**

1. Metal frame (for twin stage).
2. Stand ceramic faucet.
3. PE tube 1/4"x3meter.
4. 1/2" brass water feed adapter with 1/4" ball valve or saddle valve.

**FEATURE:**

1. All food grade material where water is contacted.
2. Long service life for ultra filtration membrane with silver fiber carbon capacity : 20,000 liters.
3. Replace inner filter only, save cost & be friendly for environment.
4. Flow rate(at 50 PSI) : 6 LPM (UF+SGAC)
5. With lead free drinking faucet NSF listed.
6. Remove bacteria (UF+SGAC).



Various inner filter



PATENT NO.  
M431736 (Taiwan)  
2517331 (China)





## TAP FILTER

- Quick change cartridge.
- Remove bacteria.
- Easy installation.
- NSF Hollow fiber membrane cartridge is available.



## TAP FILTER

- ◆ All food grade material including media & vessel
- ◆ Reminder of filter replacement.
- ◆ Quick change filter, changes in second without tool.
- ◆ Remove residue chlorine and odor.
- ◆ No waste water.
- ◆ Remove bacteria (UF+SGAC).

### PACKING LIST:

Item No.	Packing	Weight	Measurement
FF-5800	20 pcs/ctn	10.4 kgs	2,2 cu.ft
FF-20C	96 pcs/ctn	12 kgs	2,3 cu.ft
FF-20UF	96 pcs/ctn	12 kgs	2,3 cu.ft

- MOQ : ALYA BRAND : NONE  
OEM/ODM : 1000 PCS
- Dimensions (LxWxH) : 136x60x72 m/m

### STANDARD EQUIPMENT:

- Cartridge : 1. All GAC 2. UF+SGAC
- Adapter :
  1. Internal adapter AD-1C 15/16"-27 x 55/64"-27 (H:8mm)
  2. External adapter : ETA-02

### SPECIFICATION OF HOLLOW FIBER (NSF):

- Filtration hole : 0.01~0.1 micron
- Operation pressure : ≤ 50 PSI
- Temperature : ≤ 40°C

### SPECIFICATION OF CARTRIDGE:

Item No.	Media	Function	Capacity	Flow rate
FF-20C	100% granular activated carbon	Removes chlorine, chemical, bad odor	2,000 liters	2 LPM at 30psi
FF-20UF	NSF UF+ silver impregnated carbon	Removes bacteria, chlorine, bad odor	2,500 liters	2 LPM at 30psi



easy installation



change tap water to filtered water simply

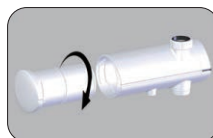

patented quick change cartridge, easy replacement



LED disply, automatically remind you for replacing cartridge



FF-20UF



### FILTER CARTRIDGE

**FF-20C**  
100% Granular coconut carbon

**FF-20UF**  
NSF hollow fiber membrane with silver impregnated carbon



**FF-5800**  
PATENT PENDING



## TAP FILTER

- Quick change cartridge.
- Remove bacteria.
- Easy installation.
- NSF Hollow fiber membrane cartridge is available.

A close-up photograph of a white, cylindrical tap filter with a silver-colored top and bottom. The filter is mounted on a chrome kitchen faucet. The brand name 'ALYA' is printed in blue on the front of the filter. In the background, a person in a light blue apron is holding a glass bowl of blueberries. In the foreground, a sink contains various fresh vegetables like bell peppers and tomatoes.

ALYA



## TAP FILTER

- ◆ Food grade material in media
- ◆ Media can be customer-made.
- ◆ Quick change filter, changes in second without tool.
- ◆ Remove residue chlorine and odor.
- ◆ No waste water.
- ◆ Remove bacteria.

### PACKING LIST:

Item No.	Packing	Weight	Measurement
FF-5600	48 pcs/ctn	18 kgs	2,26 cu.ft
FF-10C	96 pcs/ctn	16 kgs	2,26 cu.ft
FF-10UF	96 pcs/ctn	18 kgs	2,26 cu.ft

- MOQ : ALYA BRAND : NONE  
OEM/ODM : 384 PCS
- Dimensions (LxWxH) : 130x70x110 m/m

### STANDARD EQUIPMENT:

- Cartridge : 1. All GAC 2. UF+SGAC
- Adapter :  
1. Internal adapter AD-1C 15/16"-27 x 55/64"-27 (H:8mm)  
2. External adapter : ETA-02

### SPECIFICATION OF HOLLOW FIBER (NSF):

- Filtration hole : 0.01~0.1 micron
- Operation pressure : ≤ 50 PSI
- Temperature : ≤ 40°C

### SPECIFICATION OF CARTRIDGE:

Item No.	Media	Function	Capacity	Chlorine tested	Flow rate	MOQ
FF-10C	100% granular activated carbon	Removes chlorine, chemical, bad odor	3,000 liters	Under 0.75PPM	4 LPM	1008 PCS
FF-10UF	NSF UF+ silver impregnated carbon	Removes bacteria, chlorine, bad odor	UF: 6000 L SGAC: 3000 L	Under 0.75PPM	> 1 LPM at 20 PSI	1008 PCS
FF-10CRS	GAC+ Sodium less ion exchange resin	Removes scale, heavy metals	GAC: 3000 L RESIN:1200 L	Under 0.75PPM	4 LPM	1008 PCS



● Easy filter element replacement



● Kitchen faucet application



Hollow fiber membrane with silver impregnated carbon Cartridge



Filter Cartridge

**FF-10C**  
100% Granular coconut carbon

**FF-10UF**  
NSF hollow fiber membrane with silver impregnated carbon

**FF-10CRS**  
Granular coconut carbon + Sodium less resin

TAIWAN EXCELLENCE 2014

Patent no.  
M368484 (Taiwan)  
D137491 (Taiwan)  
1221836 (China)  
1504217 (China)



**FF-5600**



**FF-5601**  
Using FF-10CRS  
(GAC + Sodium less resin)



## PITCHER SERIES

- Silver impregnated coconut carbon and sodium-less cation exchange resin.  
Or full Granular coconut activated carbon only.
- All food grade material including media & vessel.



## PITCHER

- ◆ All food grade material including media & vessel.
- ◆ Remove Chlorine/pesticide/heavy metals/scale.
- ◆ Electric/tools/maintenance not required.

### PITCHER

Item No.	Cap Color	Packing	Weight	Measurement	Net Volume	Gross Volume	Carbon Capacity	Resin Capacity
PI-02W	Blue	8 pcs/ctn	9.3 kgs	3 cu.ft	2 Liters	3.5 Liters	1200 Liters	150 Liters
PI-06W	White	10 pcs/ctn	8 kgs	2.4 cu.ft	1.5 Liters	2 Liters	1200 Liters	150 Liters

- MOQ : ALYA BRAND : NONE  
OEM/ODM : 1000 PCS

### REPLACEMENT CARTRIDGE

Item No.	Media	Packing	Weight	Measurement	Flow rate
PI-3SC	Sodium-less resin bead + silver impregnated GAC	48 pcs/ctn	6.5 kgs	1.12 cu.ft	0.28 LPM
PI-3C	Granular coconut carbon only	48 pcs/ctn	6.5 kgs	1.12 cu.ft	0.28 LPM
PI-3CR	Sodium-less resin bead + GAC	48 pcs/ctn	6.5 kgs	1.12 cu.ft	0.28 LPM

### FEATURE (PI-02):

- ① Dual effect filter elements of silver impregnated bacterial inhibition
- ② Activated carbon and sodium-less ion exchange resin.
- ②-1 Diving watch type date adjustment loop.
- ③ Streamline pot water discharge design.
- ④ Handle utilizes human engineering design.
- ⑤ Water pouring mouth utilizes automatic mouth opening design.

### PI-02W

Patent no.  
M337330 (Taiwan)  
1164483 (China)

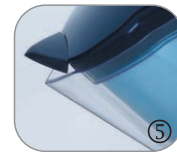
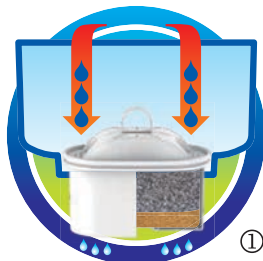

### FEATURE (PI-06):

- ① Universal cartridge, suitable for most well-known Pitcher makers.
- ② Automatic mouth opening design.
- ③ Add a special non-woven cloth in bottom of cartridge prevents carbon powder releasing.
- ④ Handy design, good for installing in the inner door of refrigerator.



PI-06W





## SHOWER FILTER SERIES

- Offer health and beauty benefits to user.
- Remove chlorine from shower water effectively.
- Clean, soften hair and skin.
- Enjoy fragrant essential oil SPA to release working pressure.



## ESSENTIAL OIL HAND SHOWER FILTER

- ◆ Press type essential oil, based on the requirement of the user to adjust the flow rate of the essential oil to avoid waste.
- ◆ Uses calcium sulfite to remove residue chlorine from tap water quickly.
- ◆ Retard your skin coarse, sensitive and aging.
- ◆ Abate falling hairs and discoloration after hair dyeing.
- ◆ back washable cartridge prolong filter lifetime.(optional)
- ◆ Easy filter element replacement  
(Recommended replacement time: 2-3 months)

Item No.	Color	Packing	Weight	Measurement	Capacity
HSF-126W	White	12 pcs	5 kgs	1.32 cu.ft	5,700 liters
HSF-126CP	Chrome	12 pcs	5 kgs	1.32 cu.ft	5,700 liters

- MOQ : ALYA BRAND : NONE  
OEM/ODM : 1000 PCS

### STANDARD EQUIPMENT:

1. Calcium sulfite cartridge (CC-48S).
2. France made essential oil : 30ml/bottle

### SPECIFICATION:

- Total capacity of pure water : 5,700 liters under 0.1 ppm chlorine
- Water pressure for best result : 40~100psi
- Require temperature : 4~40°C
- Material : ABS (Handle)
- Water flow rate : 8 LPM (8 liters/min)/at 60psi

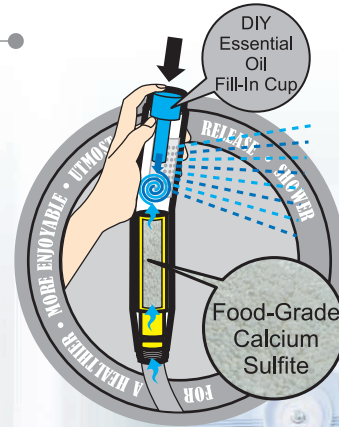

CC-48S  
Standard filter

ESOIL-LA30  
Essential oil (water soluble)

### HOW TO REPLACE FILTER & ESSENTIAL OIL HSF-126

## WALL MOUNTED SHOWER FILTER

Item No.	Cap Color	Packing	Weight	Measurement
SF-123FM	White	40 pcs/ctn	10 kgs	1.93 cu.ft

- MOQ : ALYA BRAND : NONE  
OEM/ODM : 1000 PCS
- Uses natural coconut activated carbon or to remove residue chlorine and odor from tap water quickly, for beautiful and healthy hair and skin.
- Easy filter element replacement
- May use reverse wash to extend the life of filter element.
- Retard your skin coarse, sensitive and aging.
- Slow down hair loss and discoloration after hair dyeing.

### SPECIFICATION OF CARTRIDGE:

Item No.	Media	Flow rate	Capacity
CC-35SC	Coconut + Carbon + calcium sulfite	6 LPM	9,000 liters
CC-35C	100% coconut carbon	6 LPM	3,800 liters

Applicable to many faucets, no installation problems

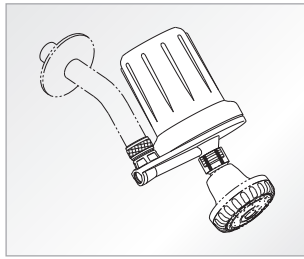
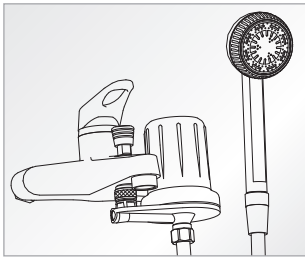

- Color: fashion white
- Dimension: 13x10x10(cm)
- Material: ABS

Patent no.  
124391 (Taiwan)  
312316 (China)



SF-123FM



Filter Cartridge  
CC-35SC  
CC-35C



## HAND SHOWER FILTER

- Offer health and beauty benefits to user.
- Remove chlorine from shower water effectively.
- Clean, soften hair and skin.

PATENT PENDING

### HAND SHOWER FILTER

Item No.	Cap Color	Packing	Weight	Measurement
HSF-127	White	60 pcs/ctn	17 kgs	1.93 cu.ft

- MOQ : ALYA BRAND : NONE  
OEM/ODM : 1000 PCS
- Ergonomics handle design.
- Uses natural coconut activated carbon or calcium sulfite to remove residue chlorine from tap water quickly, for beautiful and healthy hair and skin.
- Easy filter element replacement.
- Retard your skin coarse, sensitive and aging.
- Abate falling hairs and discoloration after hair dyeing.

### SPECIFICATION OF CARTRIDGE:

Item No.	Media	Flow rate	Capacity
CC-15CS	GAC + calcium sulfite	6 LPM	4,500 liters

Applicable to many faucets, easy installation

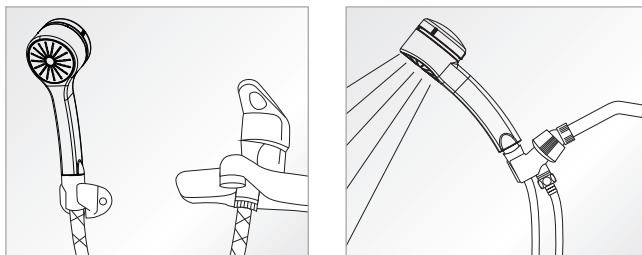

- Color: fashion white + light green (collar)
- Dimension: 28x7x7(cm)
- Material: ABS (Handle)



TRADITIONAL CARTRIDGES



**PP10-05**  
SEDIMENT CARTRIDGE  
10"x2.5" PP,  
5 MICRON



**PP10-01**  
SEDIMENT CARTRIDGE  
10"x2.5" PP,  
1 MICRON



**CBC-5CTO/05**  
CARBON BLOCK CARTRIDGE  
10"x2.5" CTO,  
5 MICRON



**CC-5K**  
COCONUT CARBON CARTRIDGE  
10"x2.5",  
(KDF+GAC)



**CC-5C**  
COCONUT CARBON CARTRIDGE  
10"x2.5" GAC,  
(100% CARBON)



**MBS 1050**  
50 GPD  
MEMBRANE 2"x12"



**MBS 1075**  
75 GPD  
MEMBRANE 2"x12"



**MBS 10100**  
100 GPD  
MEMBRANE 2"x12"

AIC IN-LINE CARTRIDGES



**AIC-10EZ(NSF)**  
10" IN-LINE GAC  
CARTRIDGE W/ QUICK  
FITTINGS(NSF APPROVED)



**AIC-10**  
10" IN-LINE CARTRIDGE  
W/ MINERAL STONE



**AIC-10NSF**  
10" IN-LINE CARTRIDGE



**AIC-10SK-EZ**  
10" IN-LINE CARTRIDGE  
W/ SILVER IMPREGNATED  
GAC,WITH QUICK FITTINGS



**AIC-12**  
12" IN-LINE GAC  
CARTRIDGE



**AIC-12EZ**  
12" IN-LINE GAC  
CARTRIDGE  
W/ QUICK FITTINGS



**AIR-12EZ**  
12" IN-LINE RESIN  
CARTRIDGE  
W/ QUICK FITTINGS



**AIC-06**  
6" IN-LINE GAC  
CARTRIDGE

**INNER QUICK CHANGE CARTRIDGE**

(For ROQ-A415E & UWF-Q231)

**QAA-10C** GAC (COCONUT)  
**QAA-10P** SEDIMENT  
**QAA-10T** CARBON BLOCK

(For ROQ-O404/O414 & UWF-Q121)

**QOO-C01** GAC (COCONUT)  
**QOO-P05** SEDIMENT

(For UWF-Q141/Q241/Q141W)

**OEV-PP5** PP  
**OEV-CT01** GAC  
**OEV-UF01** UF SGAC

**SPECIAL CARTRIDGES**

**CC-48S**  
 CARTRIDGE FOR HSF-126 SHOWER FILTER

**W13P004**  
 ESSENTIAL OIL (LAVENDER) FOR HSF-126 SHOWER FILTER

**CC-15CS**  
 FILTER CARTRIDGE FOR HSF-127 SHOWER FILTER

(For FF-5600 Faucet filter)

**FF-10CRS**  
 COCONUT CARBON + ION EXCHANGE RESIN CARTRIDGE FOR FF-5601 TAP FILTER

**FF-10UF**  
 UF + SILVER CARBON CARTRIDGE FOR FF-5600 TAP FILTER

**PI-3SC**  
 SODIUM LESS RESIN + SILVER CARBON CARTRIDGE FOR PI-02、PI-06

**PI-3CR**  
 SODIUM LESS RESIN + COCONUT CARBON CARTRIDGE FOR PI-02、PI-06

**LAMP-1**  
 REPLACEMENT UV LAMP

**QCC/QTT QUICK CHANGE CARTRIDGES (DISPOSABLE)**

(For ROQ-3404/3405/C815ST & CTMD-301)

**QCC-10P**  
 FILTER MEDIA: PP

**QCC-10C**  
 FILTER MEDIA: GAC

**QCC-10CKM**  
 FILTER MEDIA: KDF+ GAC+MINERAL STONE

**QCC-10SC**  
 FILTER MEDIA: SILVER IMPREGNATED GAC

**QCC-10USC**  
 FILTER MEDIA: SILVER IMPREGNATED GAC + HOLLOW FIBER



**QCC-10R**  
 FILTER MEDIA: RESIN

**QCC-10SCR**  
 FILTER MEDIA: RESIN+SILVER IMPREGNATED GAC

(For ROQ-T815ST & CTE-200)

**QTT-10P**  
 FILTER MEDIA: PP

**QTT-10R**  
 FILTER MEDIA: RESIN

**QTT-10SC**  
 FILTER MEDIA: SILVER IMPREGNATED GAC

**QTT-10UF**  
 FILTER MEDIA: HOLLOW FIBER + SILVER IMPREGNATED GAC

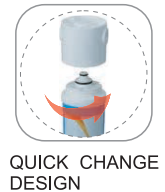





PROJECT NO (案號) : \_\_\_\_\_  
 DATE (日期) : \_\_\_\_\_  
 LOCATION FOR WATER QUALITY (EXAMPLE: NEAR SEASIDE OR MOUNTAIN)  
 (水質地點) : \_\_\_\_\_  
 A. Required capacity (需求水量) : \_\_\_\_\_  
 B. Type of user (example: use in home, school.....) (使用業別) : \_\_\_\_\_  
 C. Required quantity (需求套數) : \_\_\_\_\_

**CONTENTS OF FEEDWATER (進水水質分析)**

CHEMICAL ANALYSIS (化學離子分析項目)	ppm-mg/L	ppm as CaCO3	mEq/L
<b>CATIONS</b>			
1. Calcium (Ca++) (鈣)			
2. Magnesium (Mg++) (鎂)			
3. Total Hardness			

<b>ANIONS</b>			
1. Chloride (CL-)			
2. Sulphate (SO4)			
3. Total Anions			
4. Total Dissolved Solids			
5. Alkalinity			
6. Free Chlorine (as Cl2)(自由餘氯)			
7. Iron (as Fe)(鐵)			
8. COD (化學需氧量)			
9. BOD (生物需氧量)			

PHYSICAL ANALYSIS (物理性分析項目)	ppm-mg/L	ppm as CaCO3	mEq/L
1. Chlorate (氯鹽)			
2. Suspended Matter (M檢值)			
3. Turbidity (濁度)			
4. pH (酸鹼度)			
5. Conductivity (電導度計)			
6. Temperature (溫度)			

**INFORMATION FOR WATER SOURCE (水源資料)**

1. ORIGINAL WATER SOURCE (原始水源)	
2. FLOW RATE/SIZE OF TUBE (流量/管徑)	
3. APPLICATION (使用用途) (example: bottle water or washing chips.....etc)	
4. METHOD OF SAVING WATER (儲存方式)	

WORKING REQUIREMENT (工作需求)	
1. Average Daily Requirements (一天需求量)	M <sup>3</sup> /day
2. Number of Working Hours (一天工作時數)	H/day
3. Number of RO/DI Working Hours (RO機一天工作時數)	H/day
4. Max.Flow Rate Required (最大流量要求)	M <sup>3</sup> /day
5. Number of Hours of Max. Flow Rate (最大流量的時數)	H/day
6. Min.Flow Rate Required (最小流量要求)	M <sup>3</sup> /day
7. Product Storage Facilities M <sup>3</sup> (RO水儲量)	M <sup>3</sup>
8. Product Water Pressure Required (RO水壓力要求)	kg/cm <sup>2</sup>
9. Permissible Total Dissolved Solids(出水水質要求)	PPM
10. Sterilization Required (殺菌要求)	

POWER (電源)	
1. Voltage (電壓)	V
2. Frequency (電頻)	Hz
3. Phase (相數)	ph
4. Max. Current Available (可用總電流)	A



CIRCUMSTANCE CONDITION (環境條件) :			
1. Ambient Temperature (環境溫度)	MAX :	MIN :	
2. Special measure instrumentation and controls required (特殊測量儀器和控制要求)			
3. Available Space(裝機空間) for setting R.O. System	Length (長)	Depth (深)	Height (高) other

INFO PROVIDED BY (資料提供人員) :

OPINION (意見) :



## BRAND COMMITMENT

If you want to relish drinking potable water as you are busy at work please hand it over to  **ALYA**. We have 29-years professional experiences and listen to customers needs as good friends.  **ALYA** supplies the most suitable water filters for everyone without exaggerating and driving up prices.

No matter you are at home, at work or on trips please do remember  **ALYA** can offer you pure and healthy drinking water.

 **easywell**  
**益銳股份有限公司**  
easywell water systems, inc.

222-2, Sec. 2, Chia Tung Rd., Changhua, 50084 Taiwan  
Tel:+886-4-7363333  
fax:+886-4-7363332  
e-mail:info@easywellwater.com  
https://www.easywellwater.com



ALYA Website

We obtained :

